

V_R 300V
 I_{FAV} 200mA

Extreme fast switches

: SOD523

:

Repetitive peak reverse voltage	V_{RRM}	V		300
Reverse Voltage	V_R	V		300
Non-Repetitive Peak Forward Surge Current	I_{FSM}	A	t=8.3ms, Half sine-wave	2
Average forward current	I_{FAV}	mA		200
Power dissipation	P_D	mW		150
Thermal Resistance Junction to Ambient Air	R_{thJA}	°C/W		833
Junction temperature	T_j			150
Storage temperature range	T_{stg}			-55 to +150

$T_a=25^{\circ}\text{C}$ Unless otherwise specified

Maximum Forward voltage	V_F	V	$I_F=100\text{mA}$	1.1
Maximum Reverse current	I_R	nA	$V_R=250\text{V}$	150
Minimum Breakdown voltage	V_R	V	$I_R=100\mu\text{A}$	300
Maximum Diode capacitance	C_D	pF	$V_R=0\text{V}, f=1\text{MHz}$	5
Maximum Reverse recovery time	t_{rr}	ns	$I_F=I_R=30\text{mA}, R_L=100\Omega, I_{RR}=3\text{mA}$	50



(Example)

BAS521H	F2	Approximate 0.002	8000	80000	320000	7" reel
---------	----	-------------------	------	-------	--------	---------

(Typical)

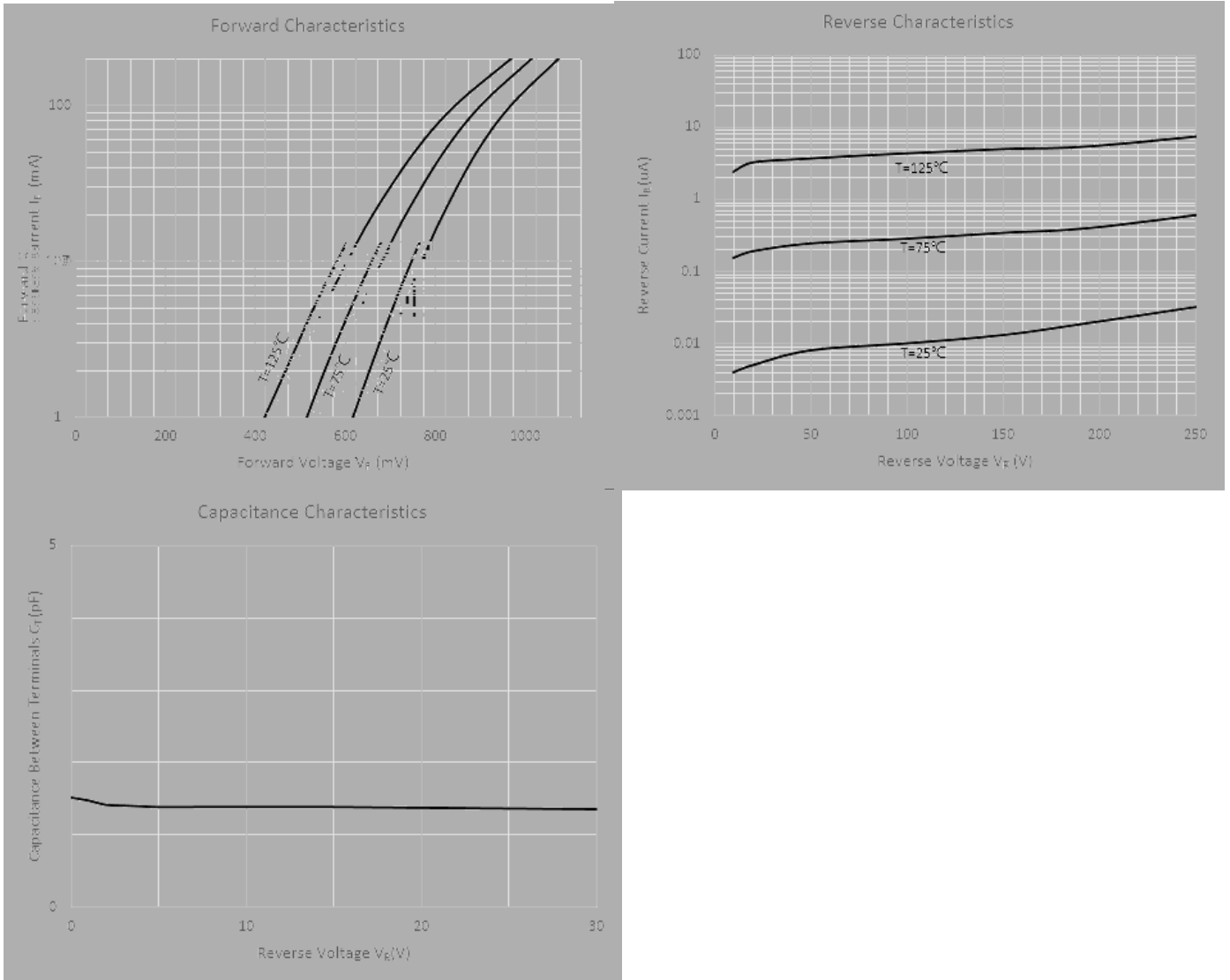



SOD-523

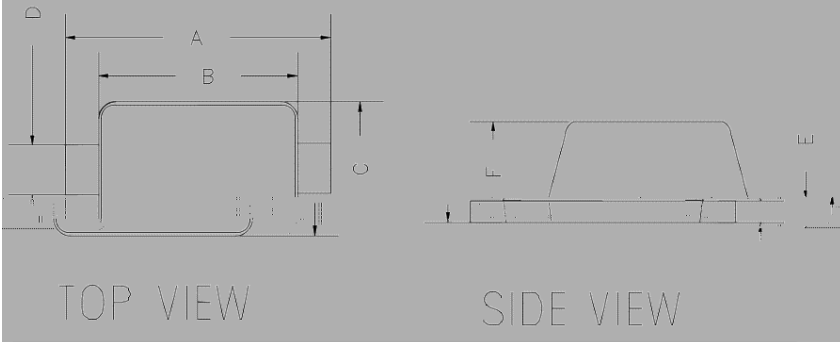

DIMENSIONS				
DIM	INCHES		MM	
	MIN	MAX	MIN	MAX
A	0.059	0.067	1.500	1.700
B	0.043	0.051	1.100	1.300
C	0.900	0.928	22.86	23.57
D	0.650	0.676	16.51	17.18
E	0.200	0.228	5.08	5.79
F	0.700	0.728	17.78	18.49

